



LCV

feeding
LCV
system



www.barbaric.at

barbaric
relieve with system •

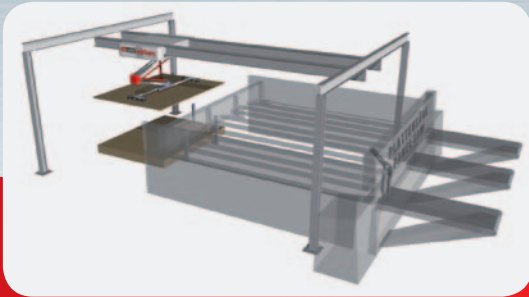

The machine is designed as modular construction, the storage can be enlarged up to any size, depending on requirement and possibility of installation in production hall.



The stacked panels can be requested either at the saw or at the "storage-PC". The software is clearly arranged and easy to handle by touchscreen.

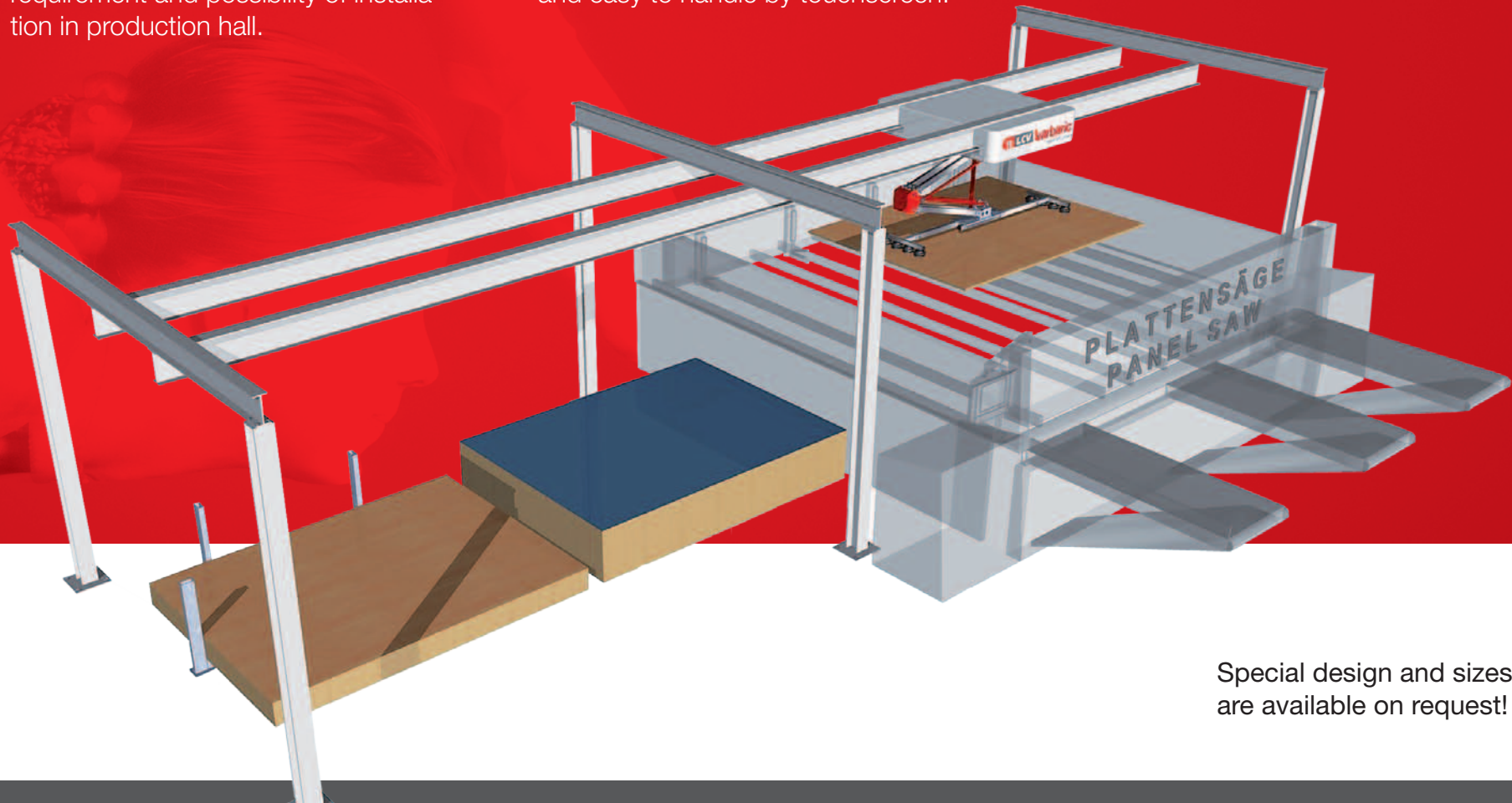

Special design and sizes
are available on request!

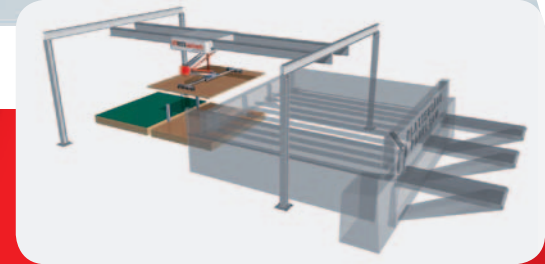
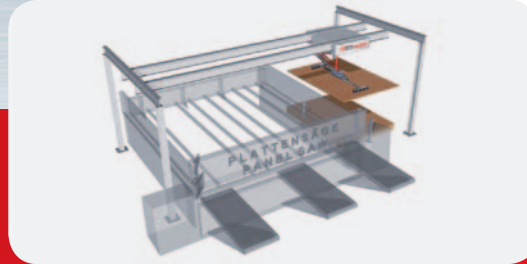
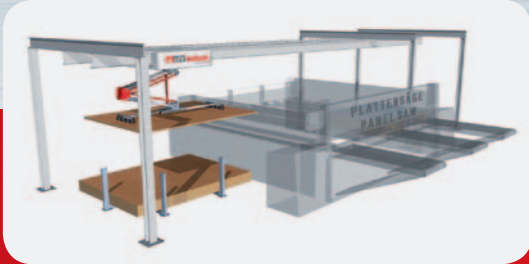

Automatic feeding system LCV

Load: max. 200 kg
 Panel size: max. 4200 x 2100 mm
 Clock cycle: from 15 sec. possible
 Stack high: 1800 mm
 Operating voltage: 400 V 500 Hz

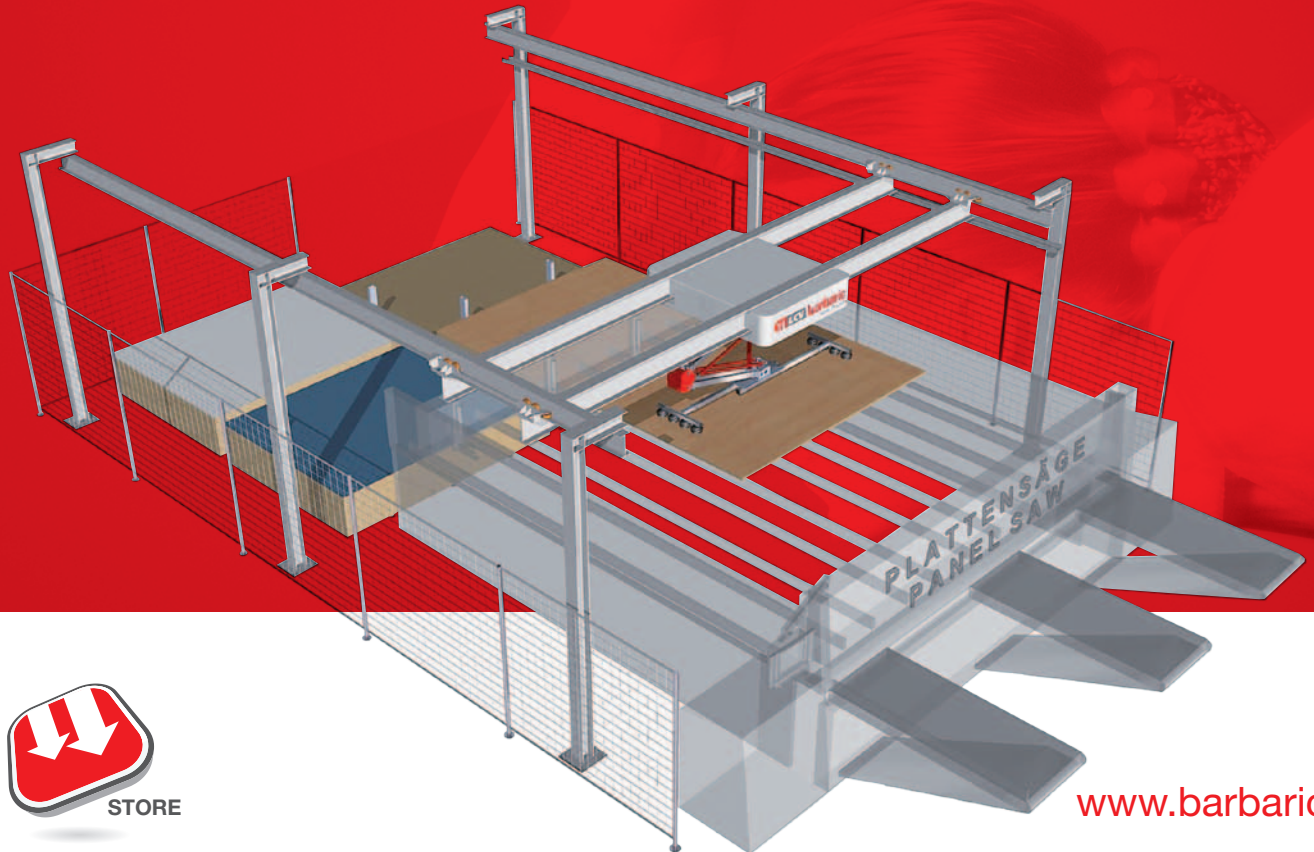

FEED



ADMINSTRATE



STORE

www.barbaric.at



- >> up to date **drive and control technology**
- >> enormous **potential in saving** space and staff costs
- >> considerable **simplification** of working process
- >> weight-optimized **construction**
- >> improved **communication** between storage system and panel saw
- >> development and realization in close **collaboration** with the customer

feeding LCV system

Barbaric GmbH, Pummererstraße 12, A-4020 Linz, Tel. +43 732 779 800
Fax +43 732 779 800-DW 10, Mail: sales@barbaric.at, www.barbaric.at

barbaric
relieve with system.