



INSTALLATION MANUAL

The dimensions given in this installation guide are based on the assumption that the topside of the washbasin countertop is placed at a height indicated in the technical data sheet (available on our website www.alke.be) of the ALKE bathroom furniture series selected by you. If you wish to deviate from the reference height specified in this technical data sheet, you should change the height measurements given in this installation guide accordingly.

BEFORE

Before you begin to hang the furniture, check each item for damage or defects when unpacking. Defects and/or missing parts that are notified to the dealer 24 hours after assembly will not be considered.

ASSEMBLED = ACCEPTED.

We recommend that you entrust the installation of your bathroom furniture to a qualified installer.

Caution! To prevent damage, never place furniture directly on the ground.

Provide a soft surface. If necessary, lay the furniture elements on the packaging material.

TOOLS & SUPPLIES

- Drill with an 8 mm diameter masonry drill bit
- Pozidriv 2 screwdriver
- Spirit level
- Pencil
- Ruler/tape measure
- Hammer
- Silicone, silicone gun

PIPING

You should hide all pipes neatly in the wall. Place the water drain perfectly in the middle of the washbasin(s) and this at the height indicated by Alke (*) above the floor level. Use 40 mm diameter PVC pipes preferably. When using PVC pipes without sealing rings, the PVC pipes must be bonded together with adhesive. Place the hot water supply to the left of the drain and the cold water supply to the right of the drain, this at the indicated height (*) above the floor level. You should fit angle stop valves on the hot and cold water supply lines to allow you to turn off the water supply only in the bathroom.

(*) See comments at the beginning of this page; for technical information, please visit our website www.alke.be.

0 DISASSEMBLY

Remove all doors and drawers from the Alke bathroom furniture to prevent damage and because it makes installation much easier. This includes the base unit, the mirror cabinet as well as the sectional cabinet. In the case of a make-up mirror cabinet, you should also remove the magnifying mirror.

0.1 REMOVING DRAWERS

***** NOTE THAT THERE ARE 2 TYPES OF DRAWERS. IDENTIFY THE TYPE FIRST BEFORE YOU BEGIN DISASSEMBLY*****

Stop dust or drill cuttings from depositing on the guides after the drawers have been removed. If this does happen, blow the dust off the guides before reinstalling the drawer. This should prevent the guides from malfunctioning.

TYPE 1

Slide the (empty!) drawer open half-way and jolt the drawer firmly upwards in a flowing motion. You can even remove the drawer front using the setscrew as shown on the second illustration.

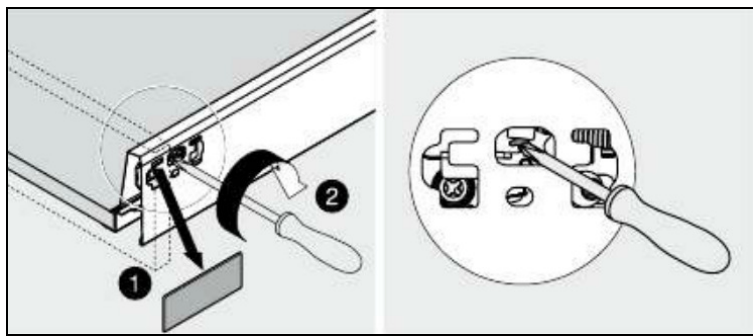
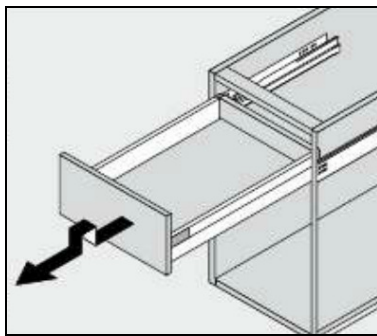

TYPE 2

Slide the (empty!) drawer open while pushing outwards the grey tabs on the guides under the drawer (1). This allows you to slide the drawer out of the cabinet in a linear motion. You can even remove the drawer front using the setscrew as shown on the second illustration. To do this, first remove the cover cap on the inside.

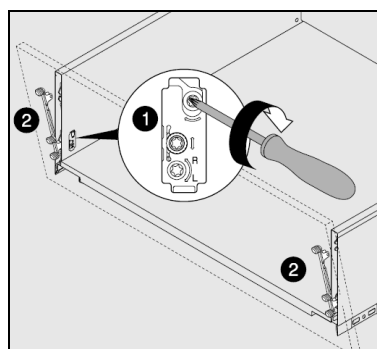
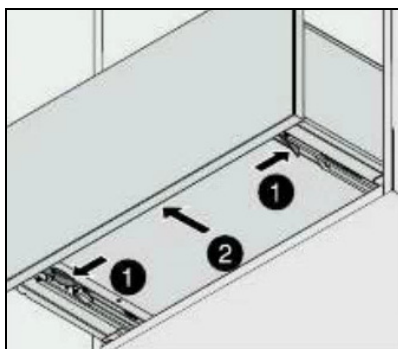

0.2 REMOVING DOORS FROM BASE UNIT AND SECTIONAL CABINET

Start by identifying the type of hinge. Use the clip at the back of the hinge to separate it from the hinge plate, mounted in the cabinet.

Type 1 (fronts of base and sectional cabinets)



Type 2 (push-open fronts)



Type 3 (Solid Surface fronts)

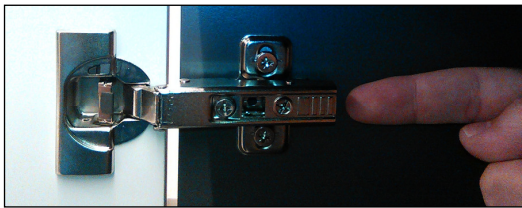

0.4 REMOVING MIRROR DOORS



Use the clip at the back of the hinge to separate it from the hinge plate, mounted in the cabinet.

0.5 ASSEMBLY SEQUENCE

1. Base unit
2. Washbasin countertop
3. Mirror cabinet
4. Free-hanging mirror
5. Tall /half-height sectional cabinet
6. Finishing

1a BASE UNIT ASSEMBLY

Before you begin to hang the furniture, check each item for damage or defects when unpacking. Defects and/or missing parts that are notified to the dealer 24 hours after assembly will not be considered.

ASSEMBLED = ACCEPTED.

We recommend that you entrust the installation of your bathroom furniture to a qualified installer.

Caution! To prevent damage, never place furniture directly on the ground.

Provide a soft surface. If necessary, lay the furniture elements on the packaging material.

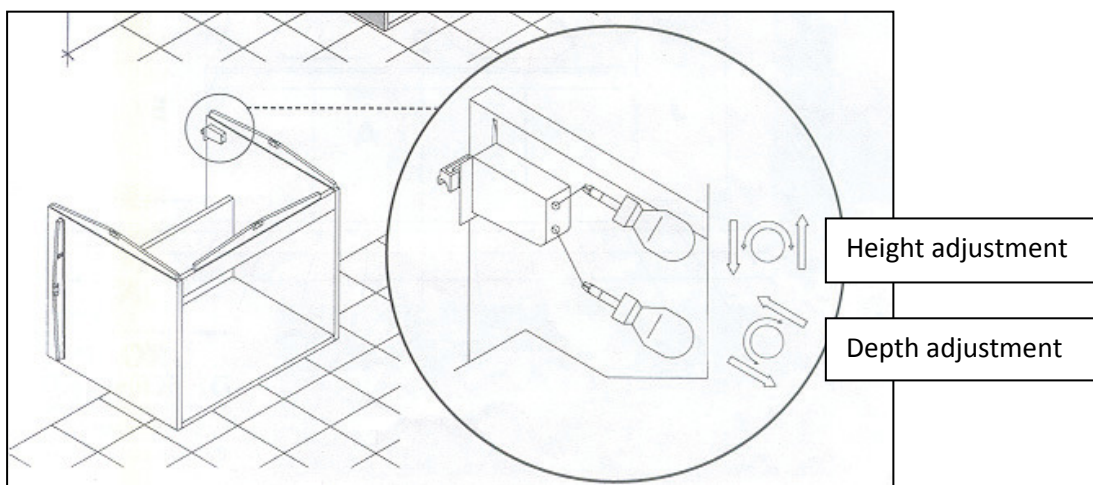

1. Draw the correct height of the washbasin on the wall (i.e. the topside of the washbasin countertop – measured on the front of the countertop).
2. Draw the thickness of the washbasin countertop on the wall (note: the thickness should be measured on the front side of the countertop). Also draw the width of the base unit on the wall.
3. Turn the lower screw (“depth adjustment”) counter clockwise (see drawing) to bring out the hanging hook until it is flush with the back of the base cabinet. Set the hanging hook to the middle position (“height adjustment”) and measure the distance from the topside of the base cabinet to the notch in this hook.
4. Draw the measured distance on the wall and this from the underside of the washbasin countertop. Using the spirit level, transfer this measurement to the other side of the cabinet.
5. Measure from the outside of the side to the centre of the hook and mark off this horizontally on the line you’ve just drawn on the wall; do the same for the other side, and apply the same principle if there are more hanging hooks.
6. The intersection of both lines is the right spot on which to place the hook. Drill the hole, remove any drill cuttings, if necessary fit the plugs in the drilled holes and screw the hook into the wall until it protrudes from the wall by 5 mm.
7. Hang the furniture element on the hooks.
8. Place the furniture fully level and at the correct height. To do this, adjust the hanging hooks with a screwdriver (“height adjustment”). Tighten the base cabinet firmly against the wall by adjusting the hanging hooks (“depth adjustment”).
9. Attach the furniture by fastening the metal brackets to the wall.
10. Repeat this if two units need to be hung side by side. In a double Madisson/Square set-up, the two cabinets must be secured together!

Before you begin to hang the furniture, check each item for damage or defects when unpacking. Defects and/or missing parts that are notified to the dealer 24 hours after assembly will not be considered.

ASSEMBLED = ACCEPTED.

We recommend that you entrust the installation of your bathroom furniture to a qualified installer.

Caution! To prevent damage, never place furniture directly on the ground.

Provide a soft surface. If necessary, lay the furniture elements on the packaging material.

HANDLE SUPPLIED SEPARATELY

If the handle is supplied separately, you must fit the handle in the furniture once you have assembled the base unit.

Place the handle in the purposely cut-out recess in the base unit, positioning it all the way against the cut-out. Screw the handle to the base unit using the supplied corner profiles.

If the handle is supplied with an LED light fixture, fit the LED as shown on the drawing below.

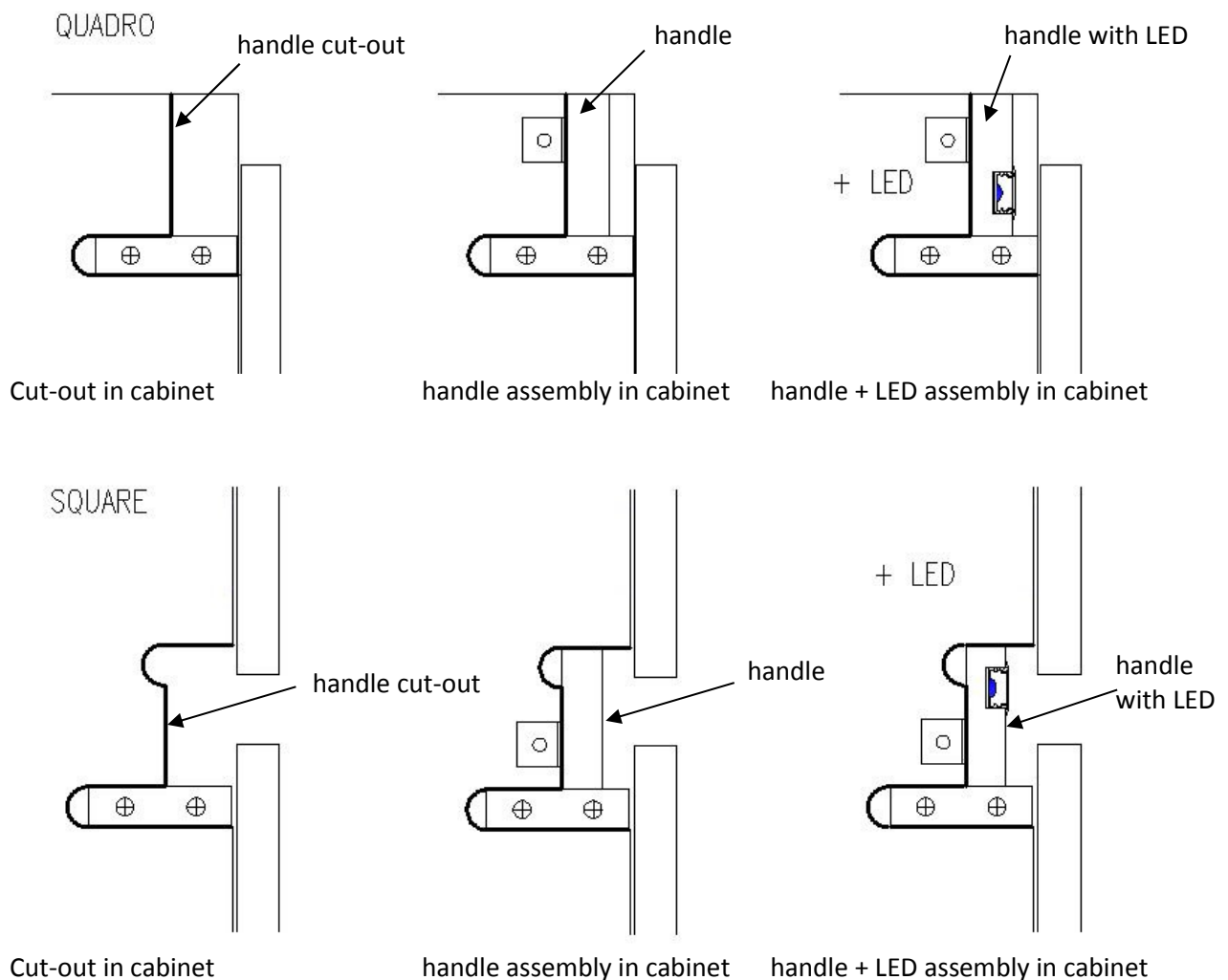

1b HILOW BASE UNIT ASSEMBLY

Before you begin to hang the furniture, check each item for damage or defects when unpacking. Defects and/or missing parts that are notified to the dealer 24 hours after assembly will not be considered.

ASSEMBLED = ACCEPTED.

We recommend that you entrust the installation of your bathroom furniture to a qualified installer.

Caution! To prevent damage, never place furniture directly on the ground.

Provide a soft surface. If necessary, lay the furniture elements on the packaging material.

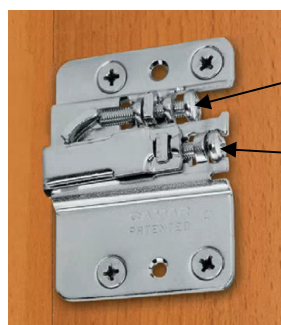
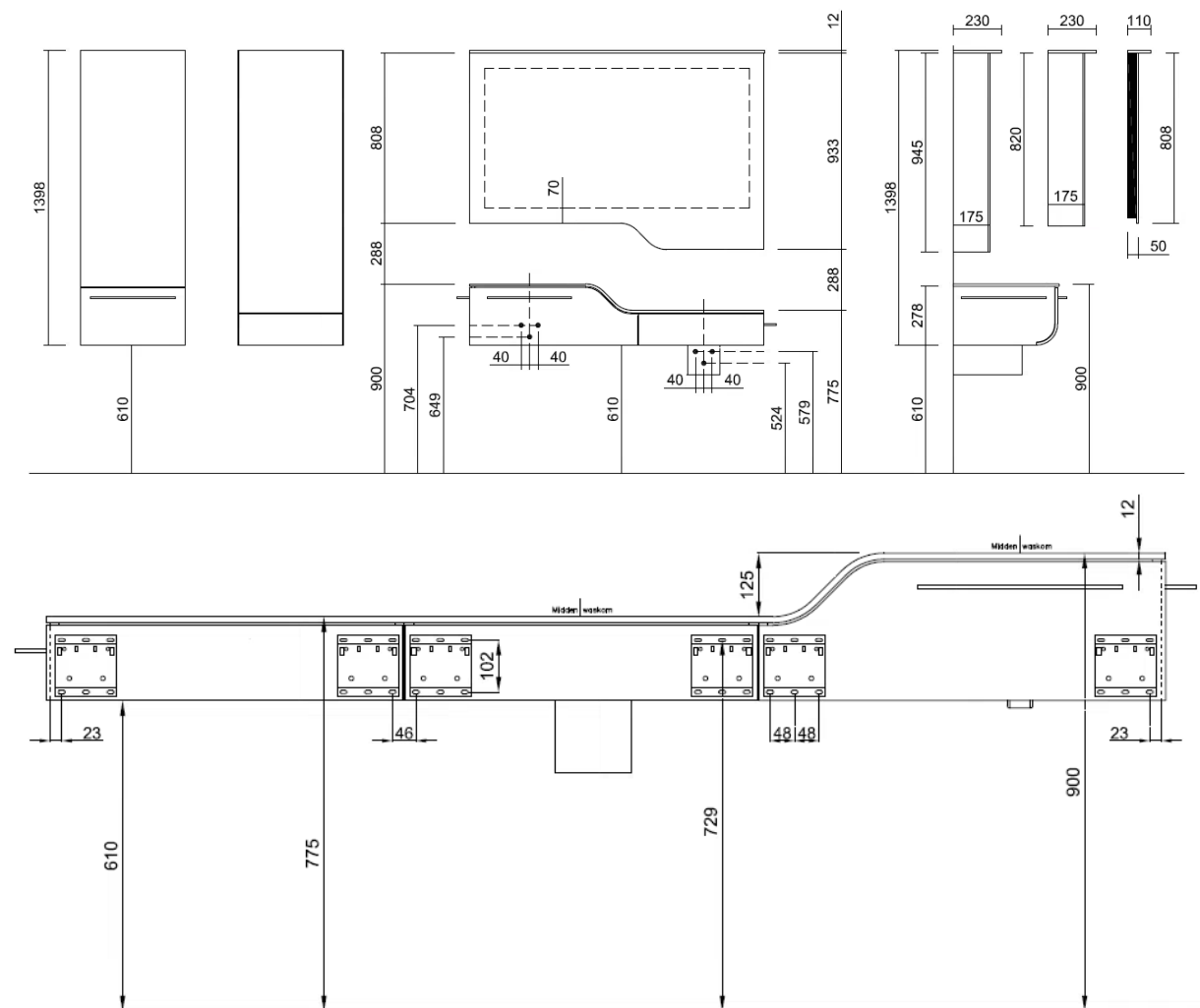

Height adjustment

Depth adjustment

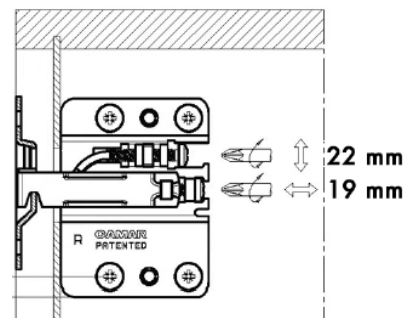

2 WASHBASIN COUNTERTOP ASSEMBLY

Before you begin to hang the furniture, check each item for damage or defects when unpacking. Defects and/or missing parts that are notified to the dealer 24 hours after assembly will not be considered.

ASSEMBLED = ACCEPTED.

We recommend that you entrust the installation of your bathroom furniture to a qualified installer.

Caution! To prevent damage, never place furniture directly on the ground.

Provide a soft surface. If necessary, lay the furniture elements on the packaging material.

1. Remove the protective film and check the countertop for damage before proceeding with the installation. Cover the countertop if you are planning to drill above its surface. The countertop is not a work bench!
2. Now that you still have the space, you should start by mounting your mixer tap(s) on to the washbasin countertop.
3. Place the washbasin countertop on the base unit, also applying some acid-free silicone to the topside of the carcass to get a watertight bond.
4. Connect the mixer tap(s) to the supply lines.
5. Attach the drain plug to the washbasin countertop and connect the drain. (DIY tip: a little washing-up liquid can do wonders when joining the pipes with sealing rings.)
6. To achieve a watertight connection, use some acid-free silicone to seal the seam between the washbasin countertop and the wall.

In the case of a porcelain washbasin:

If the washbasin is placed on top of the furniture and centred with its rear side tightly against the wall, there can be a sealant seam of at most 5 mm to the left and right of the centre line. Consequently, the washbasins included in this tolerance do not give rise to a right of complaint. If the washbasin is outside the specified tolerance, the right of complaint is only possible if the washbasin is not mounted.

In the case of a Solid Surface washbasin:

If a metal support was included (depending on the width of the finishing top and the structure of the base unit), it should be mounted to reinforce the washbasin.

The washbasins are also supplied with additional support slats in Solid Surface; these must be fastened to the wall with the corresponding plugs and screws to allow the countertop to rest on them, giving it additional support.



3 MIRROR CABINET ASSEMBLY

Before you begin to hang the furniture, check each item for damage or defects when unpacking. Defects and/or missing parts that are notified to the dealer 24 hours after assembly will not be considered.

ASSEMBLED = ACCEPTED.

We recommend that you entrust the installation of your bathroom furniture to a qualified installer.

Caution! To prevent damage, never place furniture directly on the ground.

Provide a soft surface. If necessary, lay the furniture elements on the packaging material.

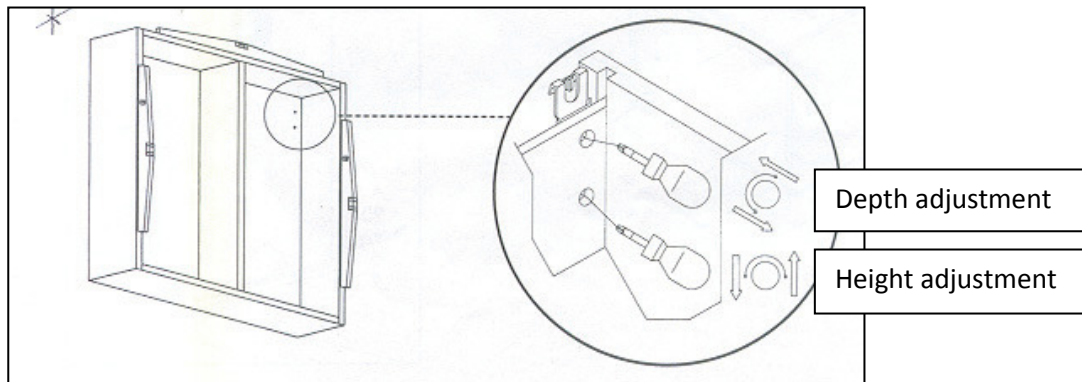

1. Use a spirit level to mark with a pencil the correct position of the mirror cabinet on the wall. (Note: If you plan to hang sectional cabinets next to it, keep in mind that you will need to match the height).
2. Turn the upper screw ("depth adjustment") counter clockwise (see drawing) to bring out the hanging hook until it is flush with the back of the mirror cabinet. Set the hanging hook to the middle position ("height adjustment"). Measure the distance from the topside of the mirror cabinet to the notch in this hook.
3. Draw the measured distance on the wall, from the topside of the mirror cabinet. Using the spirit level, transfer this measurement to the other side of the mirror cabinet.
4. Measure from the outside of the side to the centre of the hook and mark off this horizontally on the line you've just drawn on the wall; do the same for the other side, and apply the same principle if there are more hanging hooks.
5. The intersection of both lines is the right spot on which to place the hook. Drill the hole, remove any drill cuttings, if necessary fit the plugs in the drilled holes and screw the hook into the wall until it protrudes from the wall by 5 mm.
6. Now that you still have the space, you should start by fitting the tube light(s) on the mirror cabinet. Have a qualified installer connect the power, in accordance with local regulations; check that everything is functioning properly.
7. Position the mirror cabinet on the hooks.
8. Place the mirror cabinet fully level and at the correct height. To do this, adjust the hanging hooks with a screwdriver ("height adjustment"). Tighten the mirror cabinet firmly against the wall by adjusting the hanging hooks ("depth adjustment").
9. Repeat this if two cabinets need to be hung side by side in a double set-up! Both cabinets must be secured **together**.

4 FREE HANGING MIRROR ASSEMBLY

Before you begin to hang the furniture, check each item for damage or defects when unpacking. Defects and/or missing parts that are notified to the dealer 24 hours after assembly will not be considered.

ASSEMBLED = ACCEPTED.

We recommend that you entrust the installation of your bathroom furniture to a qualified installer.

Caution! To prevent damage, never place furniture directly on the ground.

Provide a soft surface. If necessary, lay the furniture elements on the packaging material.

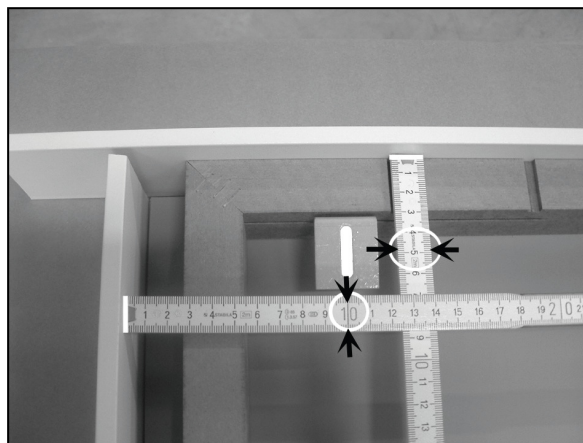

1. Use a spirit level to mark with a pencil the correct position of the free-hanging framed mirror on the wall. Note: If you plan to hang sectional cabinets next to it, keep in mind that you will need to match the height.
2. Measure the topside of the mirror and the side of the mirror as shown above. (DIY tip: laying the mirror down in a corner makes it easy to take the measurements.)
3. Draw the measured distances on the wall.
4. The intersection of both lines is the right spot on which to place the hooks.
5. Drill the hole, remove any drill cuttings, if necessary insert the plugs into the drilled holes and screw the hooks into the wall.
6. Now that you still have the space, you should start by fitting the tube light(s) to the wooden frame. Leave a few mm of space between the mirror and the luminaire! They should not come in contact. Have a qualified installer connect the power, in accordance with local regulations; check that everything is functioning properly.
7. Position the mirror on the hooks.
8. Place the mirror fully level and at the correct height. The hooks are height adjustable by properly positioning them in the vertical slotted hole.

5 TALL/HALF-HEIGHT SECTIONAL CABINET ASSEMBLY

Before you begin to hang the furniture, check each item for damage or defects when unpacking. Defects and/or missing parts that are notified to the dealer 24 hours after assembly will not be considered.

ASSEMBLED = ACCEPTED.

We recommend that you entrust the installation of your bathroom furniture to a qualified installer.

Caution! To prevent damage, never place furniture directly on the ground.

Provide a soft surface. If necessary, lay the furniture elements on the packaging material.

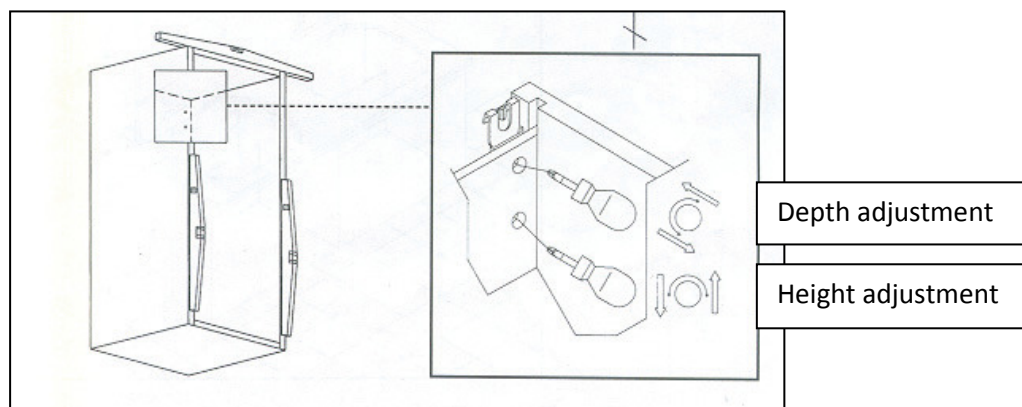

1. Use a spirit level to mark with a pencil the correct position of the half-height/tall sectional cabinet on the wall.
2. Turn the upper screw ("depth adjustment") counter clockwise (see drawing) to bring out the hanging hook until it is flush with the back of the sectional cabinet. Set the hanging hook to the middle position ("height adjustment"). Measure the distance from the topside of the half-height/tall cabinet to the notch in this hook.
3. Draw the measured distance on the wall and this from the topside of the half-height/tall sectional cabinet. Using the spirit level, transfer this measurement to the other side of the half-height/tall sectional cabinet.
4. Measure from the outside of the side to the centre of the hook and mark off this horizontally on the line you've just drawn on the wall; do the same for the other side.
5. The intersection of both lines is the right spot on which to place the hook. Drill the hole, remove any drill cuttings, if necessary fit the plugs in the drilled holes and screw the hook into the wall until it protrudes from the wall by 5 mm.
6. Position the half-height/tall sectional cabinet on the hooks.
7. Place the half-height/tall sectional cabinet fully level and at the correct height. To do this, adjust the hanging hooks with a screwdriver ("height adjustment"). Tighten the sectional cabinet firmly against the wall by adjusting the hanging hooks ("depth adjustment").
8. In the case of a half-height cabinet: use the screws supplied to secure the finishing top from the inside of the cabinet.
9. Repeat this if two cabinets need to be hung side by side in a double set-up! Both cabinets must be secured **together**.

6 FINISHING

Now that the whole furniture structure has been hung, you can reassemble the doors and drawers.

6.1 Assembly and adjustment of the hinges of the ordinary doors

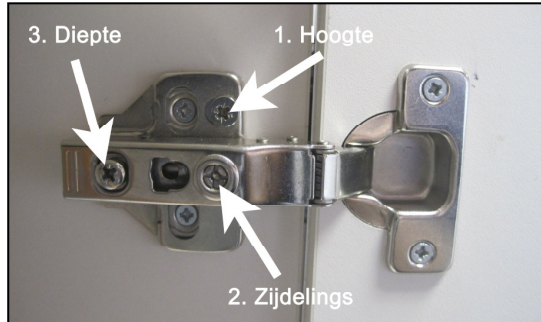

To hang the door back, attach the hinge to the hinge plate using the clip at the back of the hinge. If you hear a click, this means the door is securely in place.

Now, you can adjust the door with the set screws 1, 2 or 3. These are used to move the door up and down (1), sideways (2) and forwards and backwards (3).

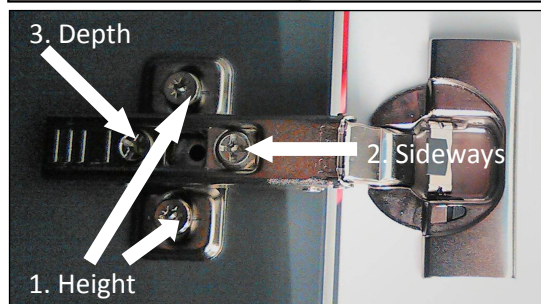

6.2 Assembly and adjustment of the hinges on double-sided mirror doors

To refit the door to the cabinet, attach the hinge to the hinge plate using the clip at the back of the hinge. If you hear a click, this means the door is securely in place.

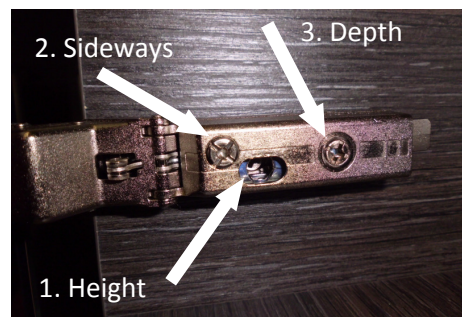

Now, you can adjust the door with the set screws 1, 2 or 3. These are used to move the door up and down (1), sideways (2) and forwards and backwards (3).

When making the final adjustment to the hinges, please make sure the hinges are not under stress to prevent glass breakage.

6.3 Drawer assembly

Stop dust from getting inside the guides. If this does happen, blow the dust off the guides before reinstalling the drawer. This should prevent the guides from malfunctioning.

TYPES 1 and 2

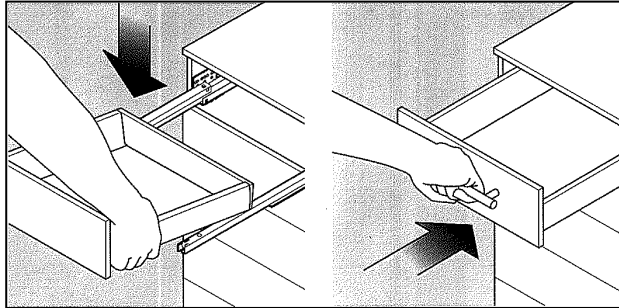

Pull the guides all the way out and place the drawer approximately half-way on the guides. Now close the drawer. The drawer automatically slides into the guides. As a test, open and close the drawer again. As you can see, it slides perfectly in and out. If this fails, check that the drain or the pipes supplying the taps are not pressing against the drawer and try again.

6.4 Drawer adjustment

TYPE 1

You can click the drawer front onto the sides of the drawer.

Hidden under the grey cover, you will find the drawer's adjustment screws.

You can use the setscrew 1 to adjust the front laterally.

You can use the second setscrew (setscrew 2) to move the front up and down.

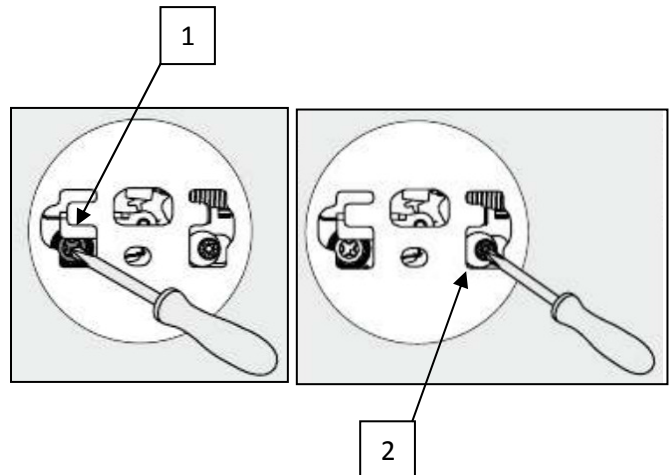

TYPE 2

You can click the drawer front onto the sides of the drawer.

Hidden under the grey cover, you will find the drawer's adjustment screws.

You can use setscrew 1 to move the front up and down (height).

You can use setscrew 2 to move the front sideways.

You can use set screw 3 to tilt the front.

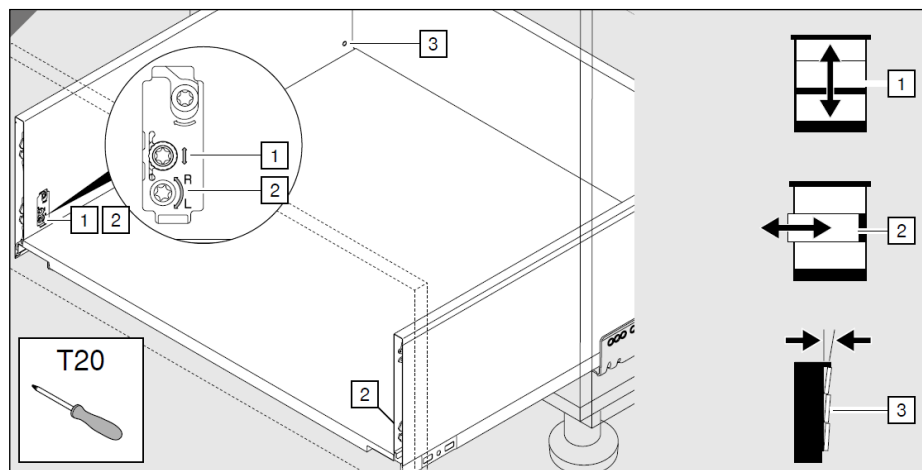

***** IF YOU DON'T SUCCEED IN PROPERLY ADJUSTING THE FRONTS, YOU WILL NEED TO RE-ADJUST THE BASE UNIT A LITTLE MORE BY FOLLOWING THE INSTRUCTIONS BELOW*****

Suspension system type 1

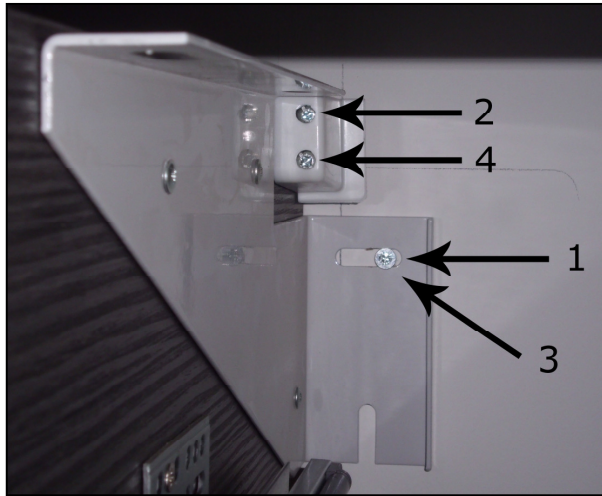

1. Completely loosen this screw
2. Turn this screw to adjust the height of the furniture (higher or lower)
3. Once the desired height has been reached, tighten this screw again
4. This screw ensures that the furniture is secured to the wall
5. Then re-adjust the fronts.

Suspension system type 2:

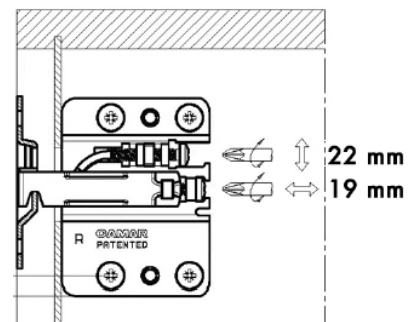
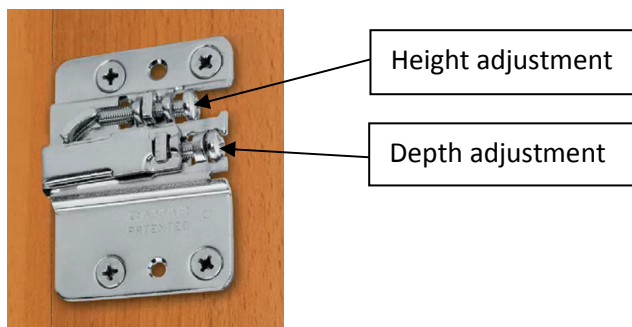

6.5 Soft close system

The shock absorber is contained in the hinge.

ADJUSTMENT OF MIRROR HINGE SHOCK ABSORBER

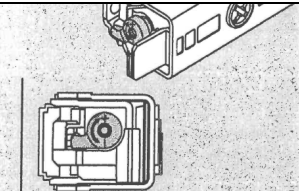
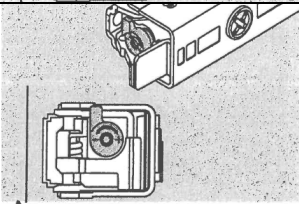
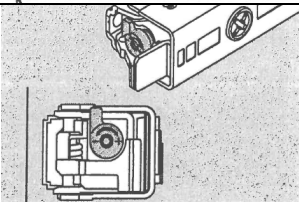
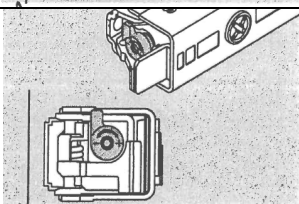
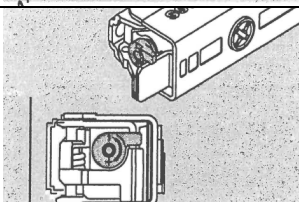
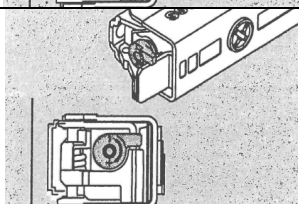
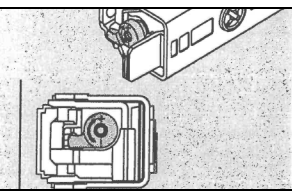
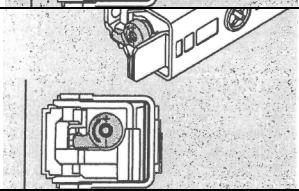
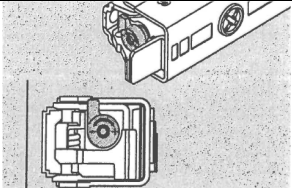
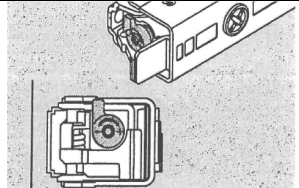
Height x Width mirror door	Top hinge	Bottom hinge
67.5 x 14.5	Without shock absorber	
67.5 x 19.5	Without shock absorber	
67.5 x 27	Without shock absorber	
67.5 x 34.5	Without shock absorber	
67.5 x 39.5	Without shock absorber	
67.5 x 44.5	Without shock absorber	
67.5 x 49.5		
67.5 x 59.5		

6.6 Push-open system

The depth of the drawer might have to be readjusted if the push-open system does not work properly.

If the drawer is too much against the carcass, you won't be able to push the drawer far enough to activate the system.

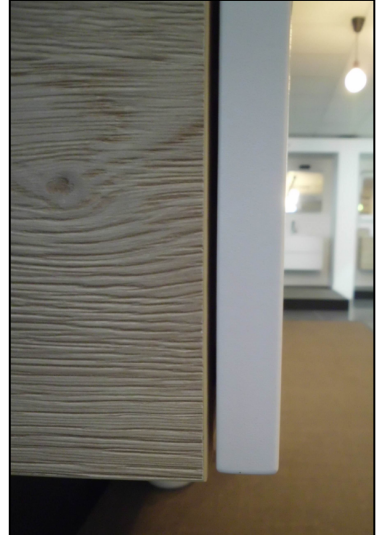
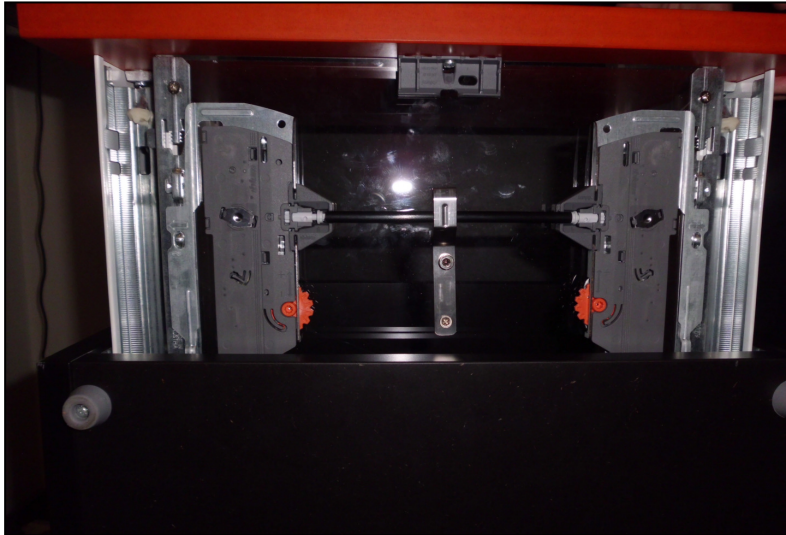

You can adjust the depth of the drawer by turning the 2 orange toothed wheels underneath the drawer.

This causes the front to come out more, giving you more room to push the drawer in and activate the system.

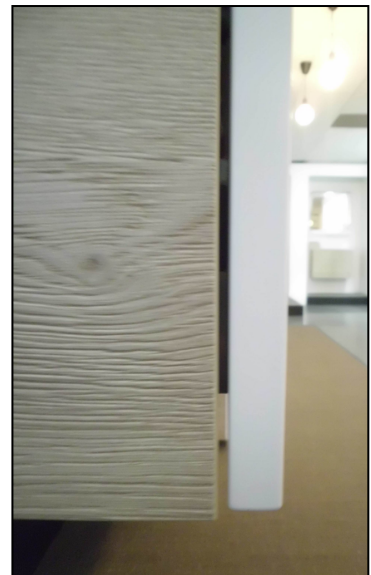
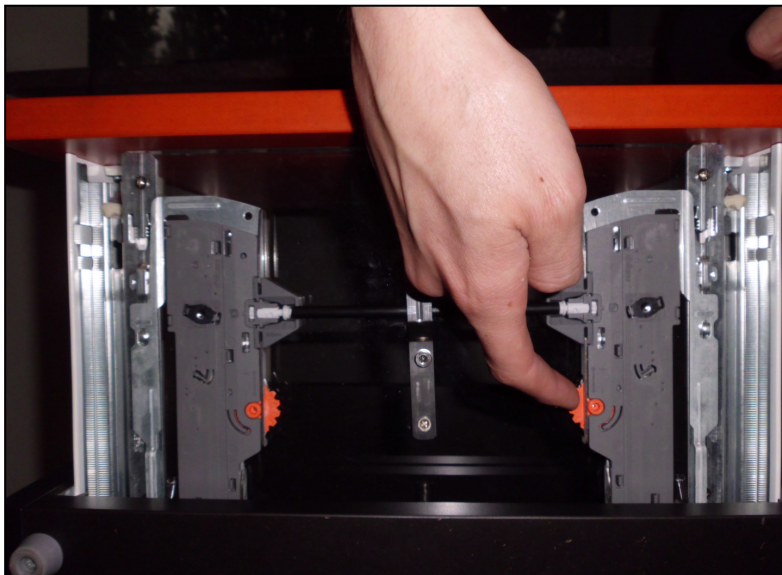

7 MAINTENANCE TIPS

Dry off all furniture elements after each use!

7.1 Maintenance tips for mirror doors and mirror panels

- Immediately wipe off water splashes/droplets and condensation appearing on the edge of the mirror.
- Never use cleaning products containing ammonia.
- Never spray acidic, alkaline, descaling or abrasive products on the mirror edge, as these will damage it.
- You can use a soft cloth lightly moistened with lukewarm water to remove stains and cosmetics.

7.2 Maintenance tips for lighting fixtures

- Allow the luminaire to cool down sufficiently before you start cleaning it.
- Never use a liquid cleaner or damp cloth. Use a dry cloth instead.

7.3 Maintenance tips for a washbasin unit

- Make sure ventilation is working well.
- Never leave wet or damp items inside or on the furniture and dry wet furniture items immediately with a soft cloth.
- Never use abrasive or aggressive cleaning agents or hard cleaning cloths or scouring pads. Use a soft, damp cloth.
- Never place a piece of furniture in the immediate vicinity of a bathtub or shower without a fixed partition.

7.4 Maintenance tips for an engineered stone washbasin

- The washbasin must be treated with care for a month until fully cured. Use water and soap to clean the surface. Never use a cleaning product containing abrasives. The countertop must be protected against acids, toilet cleaners, drain cleaners, hair colour rinses, and chlorine.
- Rubbing car wax regularly into the washbasin will polish the surface and help reduce small scratches. If you do this, you will also improve the water repellency of the top layer.
- If the washbasin's drain is clogged, you should use a plunger. Don't use any acid or alkali-containing drain unblockers.
- Avoid using excessively hot water. Water above 60°C causes hairline cracks in the long term!

7.5 Maintenance tips for a porcelain washbasin

- Clean the washbasin with a soft cloth and clear water. Don't use abrasive cleaners!
- Avoid using excessively hot water, as this could cause the glaze layer to burst.
- Scratches caused by metal objects, e.g. a ring, can be removed with a porcelain eraser.
- Don't allow toothpaste with amine fluoride to attack the porcelain. Clean that spot immediately.
- Stubborn stains and limescale deposits can be removed with vinegar cleaners.

7.6 Maintenance tips for a Solid Surface washbasin

- Clean your countertop daily with a damp cloth and the usual soft detergents. Remove dirt and stains immediately.

- Immediately remove with turpentine or acetone adhesive and sealant residues that may have been left on the countertop during installation, and clean the surface right away.
- You should remove limescale deposits with a vinegar cleaner or a descaler in accordance with the instructions on the packaging.
- Never use aggressive cleaners such as chlorine, oven cleaners or drain unblockers.
- Stubborn stains can be removed using a scouring pad and an abrasive cleaner (e.g. Chemico). This will make sure you also preserve the material's original gloss. Never use CIF. CIF has a hard grain and leaves scratches on the surface.
- Heavy objects can cause scratches if pushed on the surface.
- Traces of use or scratches on the surface can be removed using an abrasive cleaner or a scouring pad (Scotch Brite). In this case, in order to avoid variations in the gloss or shades, it is recommended to treat the entire surface. In case of more important damage or the occurrence of cracks, it is possible to repair the surface with a filler, without leaving any traces. This must be done by trained personnel, however.

7.7 Maintenance tips for a natural stone washbasin

- Before use, rub olive oil into the washbasin for extra protection.
- Natural stone is porous. This means that it is susceptible to staining. Consequently, clean immediately after spills; keep the surface dust free; do not allow deposits of any kind (make-up, water, etc.); rinse the washbasin thoroughly after use and wipe it dry with a soft cloth.
- Acids and alkali destroy the glossy top layer. The following should be absolutely avoided: acidic toilet and tile cleaners, ammonia, abrasive cleaners or paste, vinegar, alcohol, glass cleaners, scouring pads, steel wool, lemon.
- Natural stone is not resistant to all kinds of stains and scratches. A water repellent sealer counteracts the ingress of liquids. The treatment does not mean that the surface is fully protected. The only true protection layer is the polished top layer of the countertop. It is therefore advisable to protect the stone surface at least once a year with a professional sealer. You can buy it in a DIY shop. Follow the manufacturer's instructions.

7.8 Maintenance tips for a Crystal glass washbasin

- Countertops made from Crystal glass have a modern look, are strong enough for intensive daily use and remain beautiful under normal use and maintenance conditions.
- Clean your countertop daily with a damp cloth and the usual soft (non-abrasive) detergents.
- The best way to remove limescale is with vinegar dissolved in a little water.